

## Puget Sound's 2009 Construction Season

2009: Plan ahead – [www.wsdot.wa.gov/construction/2009](http://www.wsdot.wa.gov/construction/2009)

### Major construction ahead in central Puget Sound region

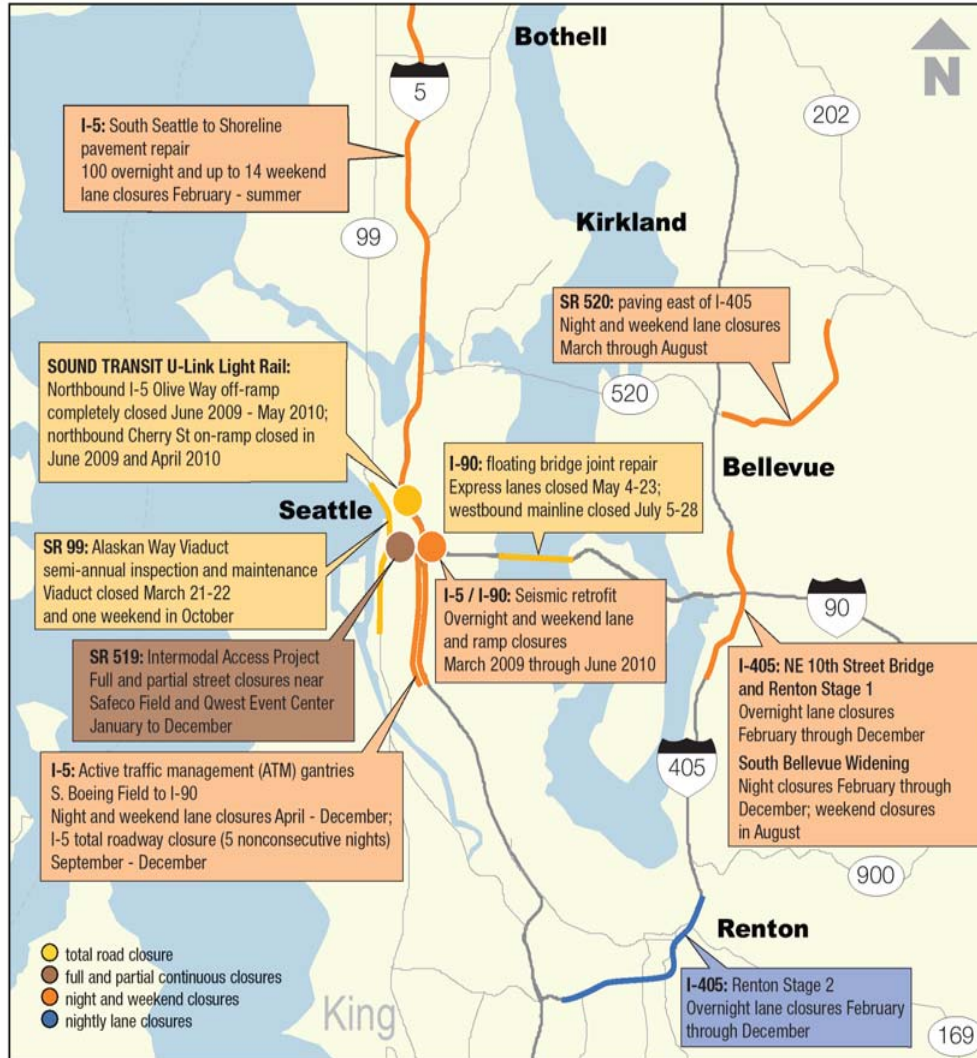

**KNOW BEFORE YOU GO**



### I-5 Seattle to Shoreline Pavement Repair Project Map

2009: Plan ahead – [www.wsdot.wa.gov/construction/2009](http://www.wsdot.wa.gov/construction/2009)

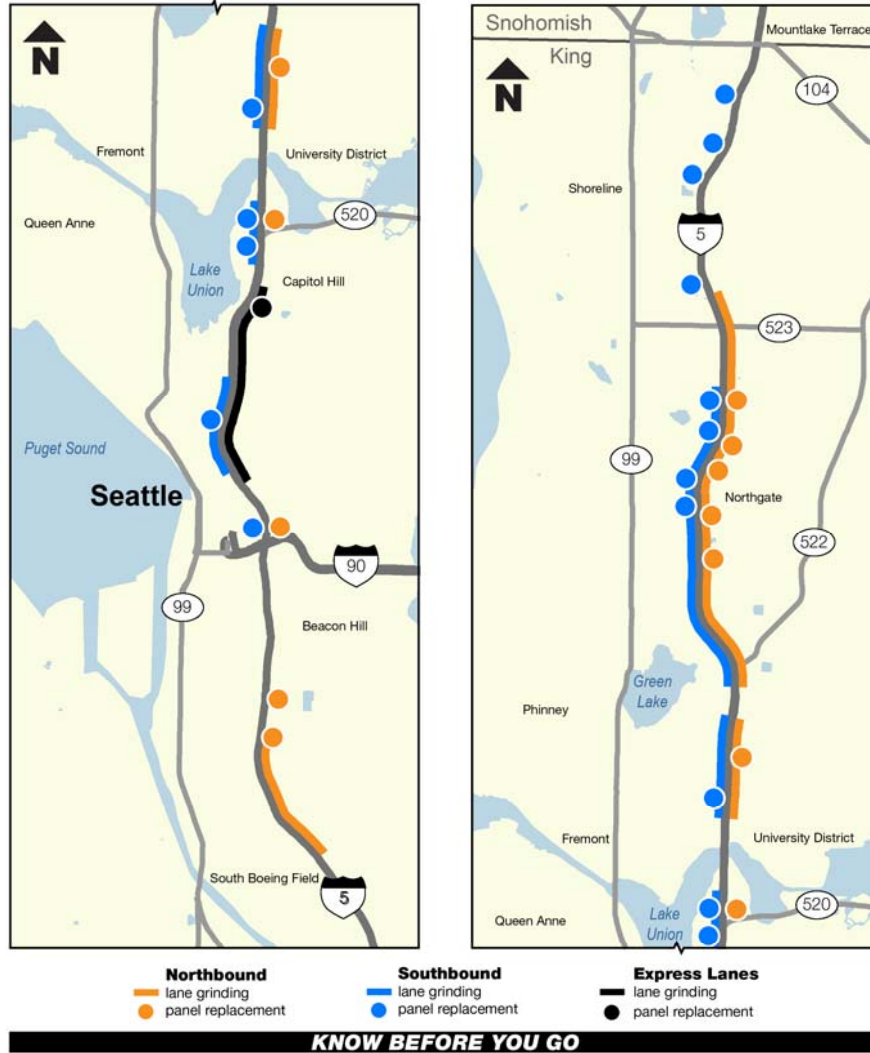



2009 Design Construction Conference



2009 Design Construction Conference

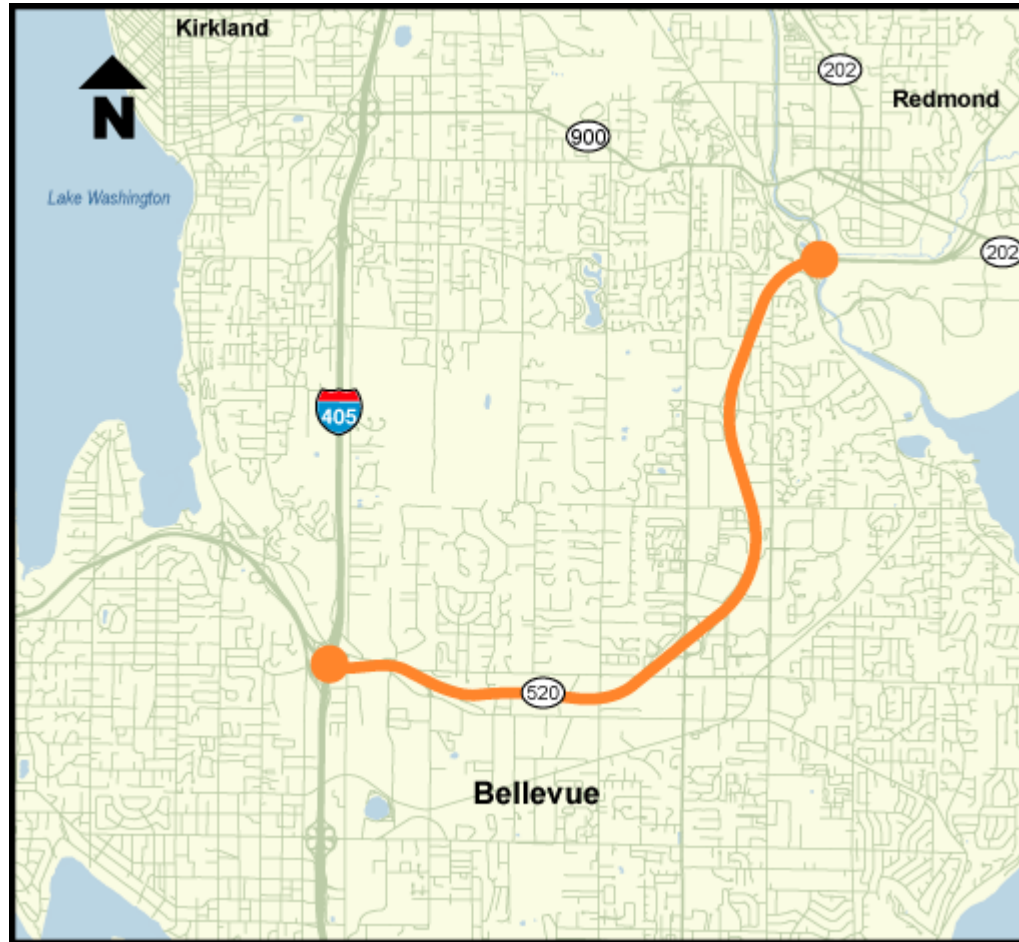

2009 Design Construction Conference



2009 Design Construction Conference

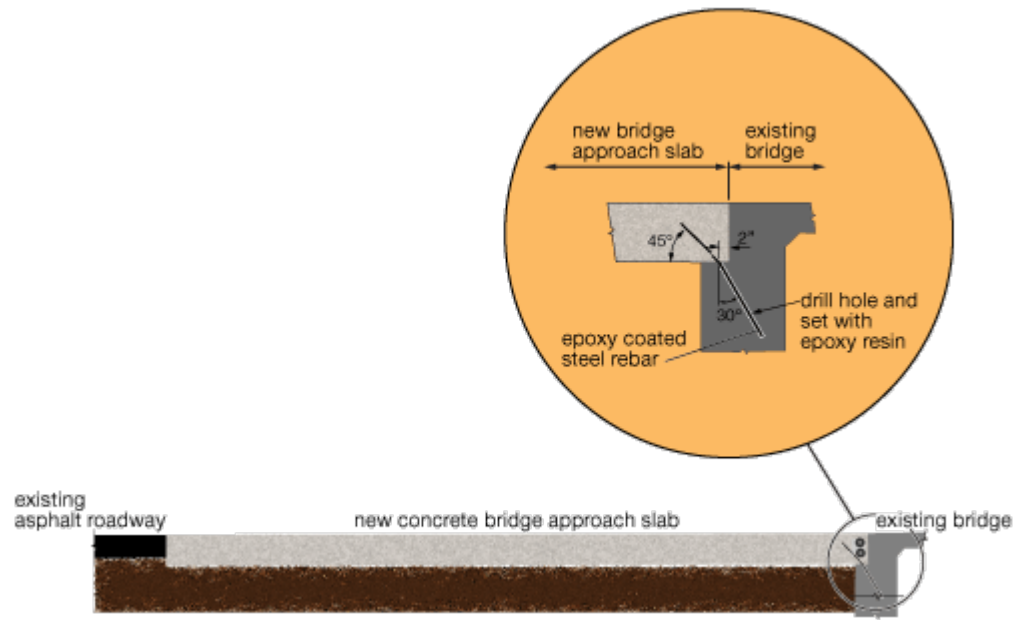





2009 Design Construction Conference



2009 Design Construction Conference



2009 Design Construction Conference

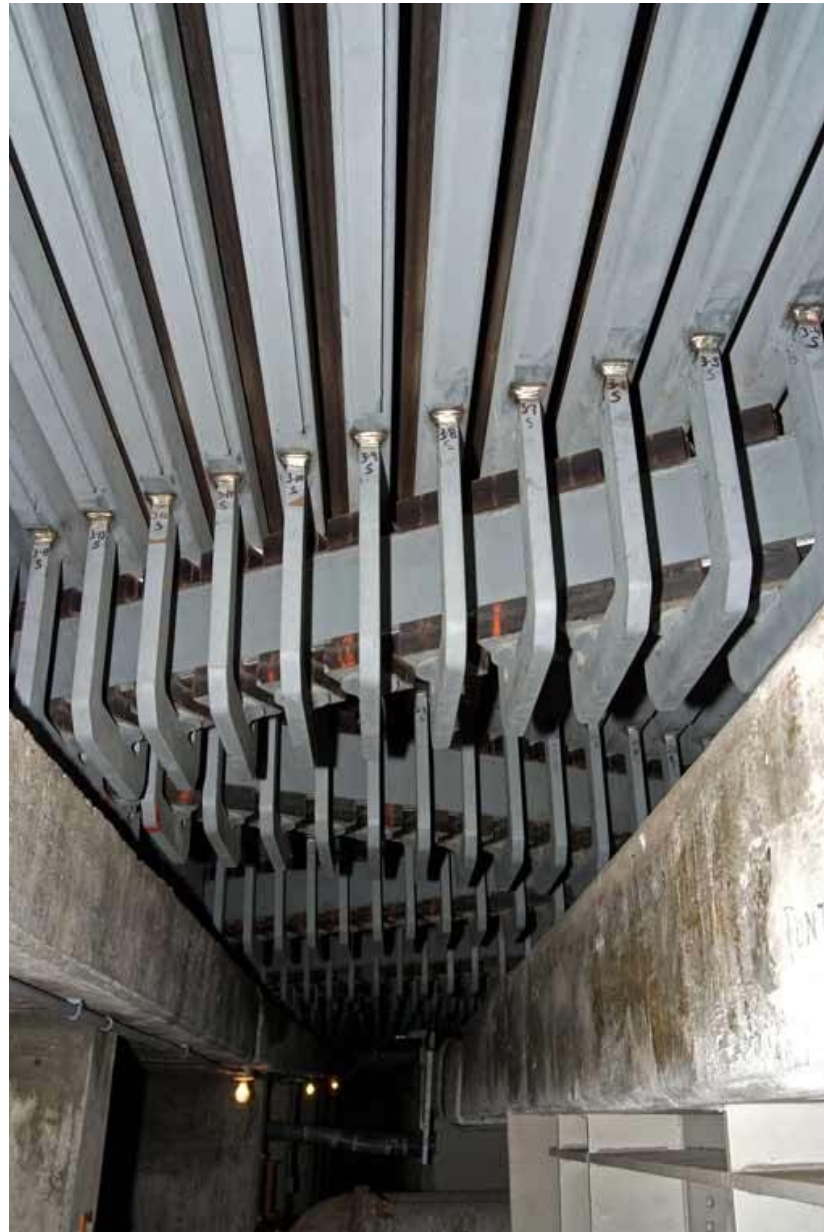

2009 Design Construction Conference

# May 2009 I-90 express lane closure



Lake Washington

First Hill Lid

Westbound mainline on-ramp open

Westbound mainline on-ramp open

Westbound express lane on-ramp closed

Westbound mainline open

Express lanes closed



Eastbound mainline open

Mount Baker Tunnel

Eastbound mainline lane off-ramp open

Eastbound mainline lane off-ramp open

- Closed ramps and lanes
- ← Open ramps and lanes

All lanes of the I-90 express lanes will be closed to westbound traffic between Island Crest Way on Mercer Island and Seattle from May 4-23.

Mercer Island

SE 40th St

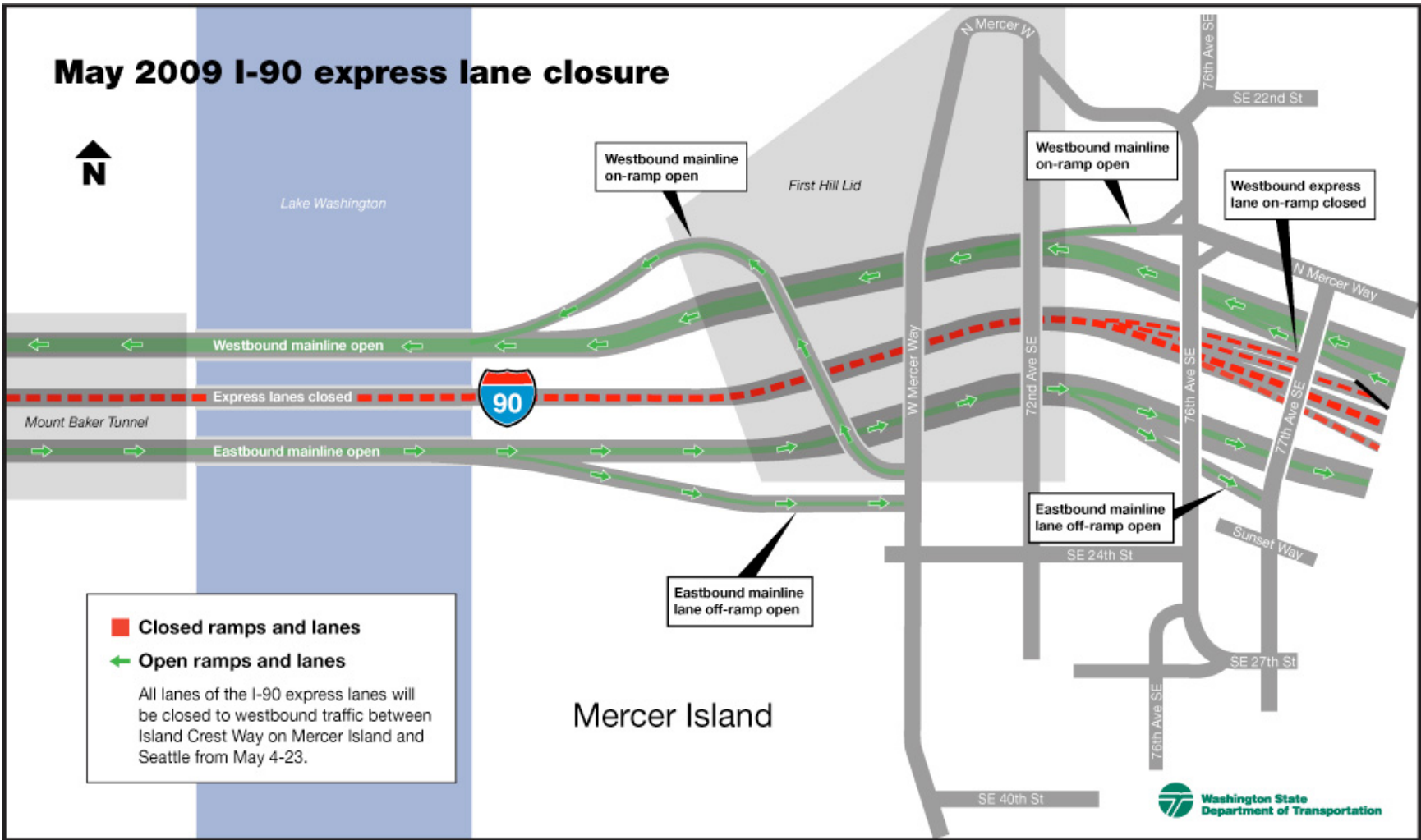

# July 2009 westbound I-90 mainline closure

Mercer Island

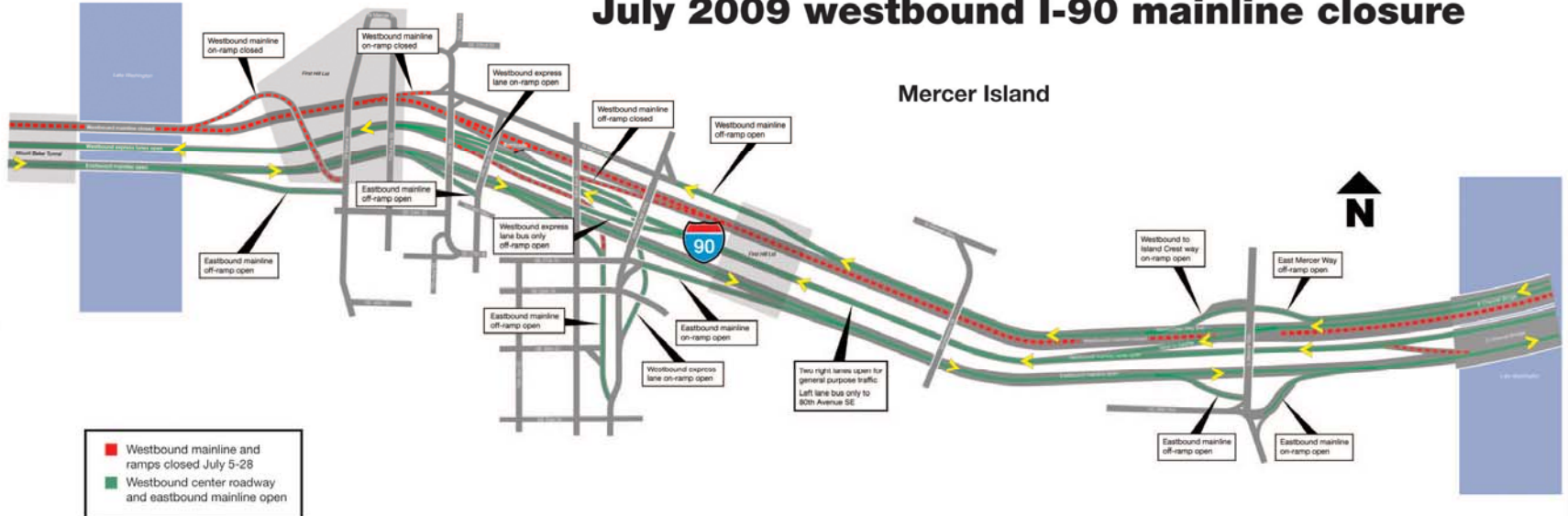

# July 2009 westbound I-90 mainline closure

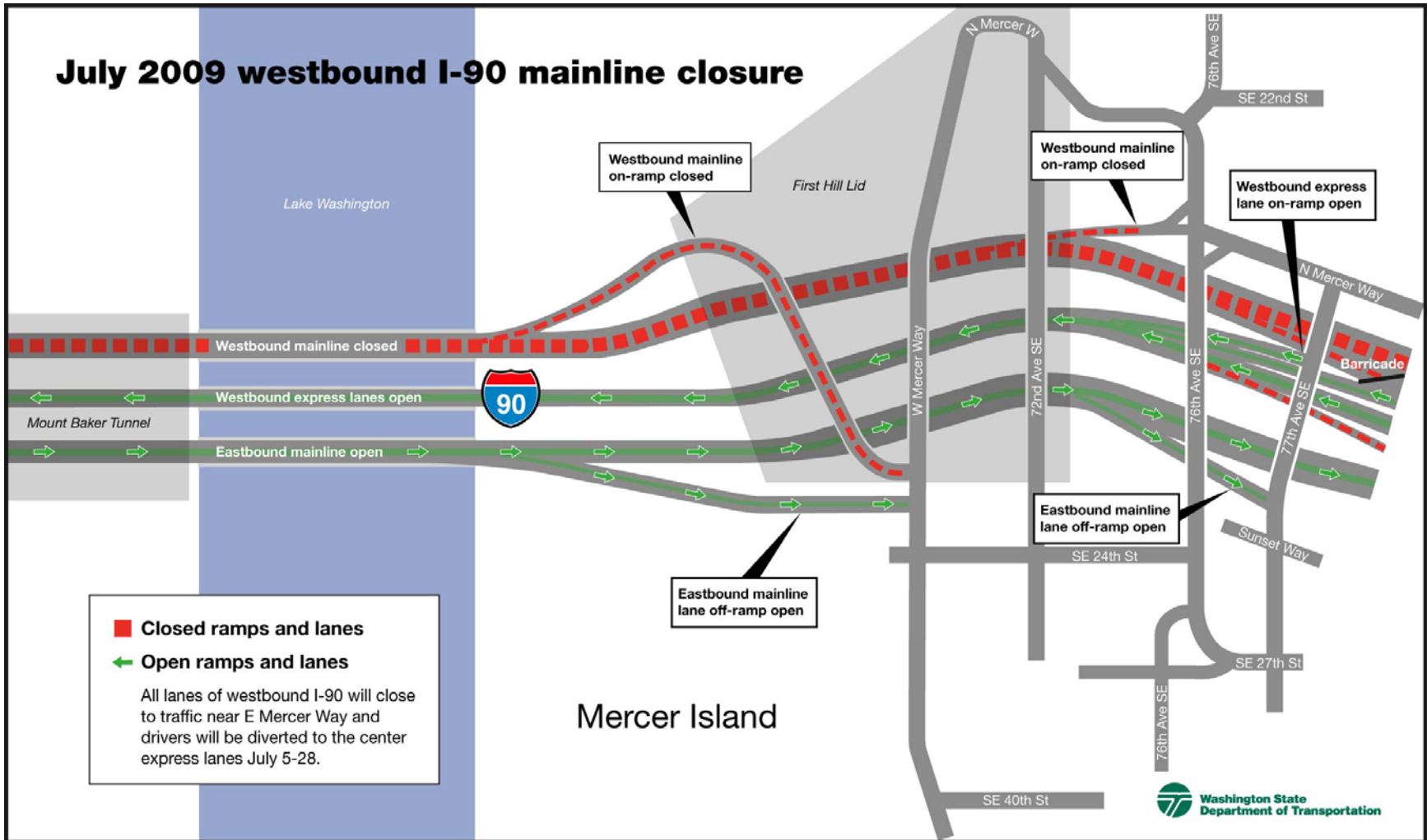

# July 2009 westbound I-90 mainline closure

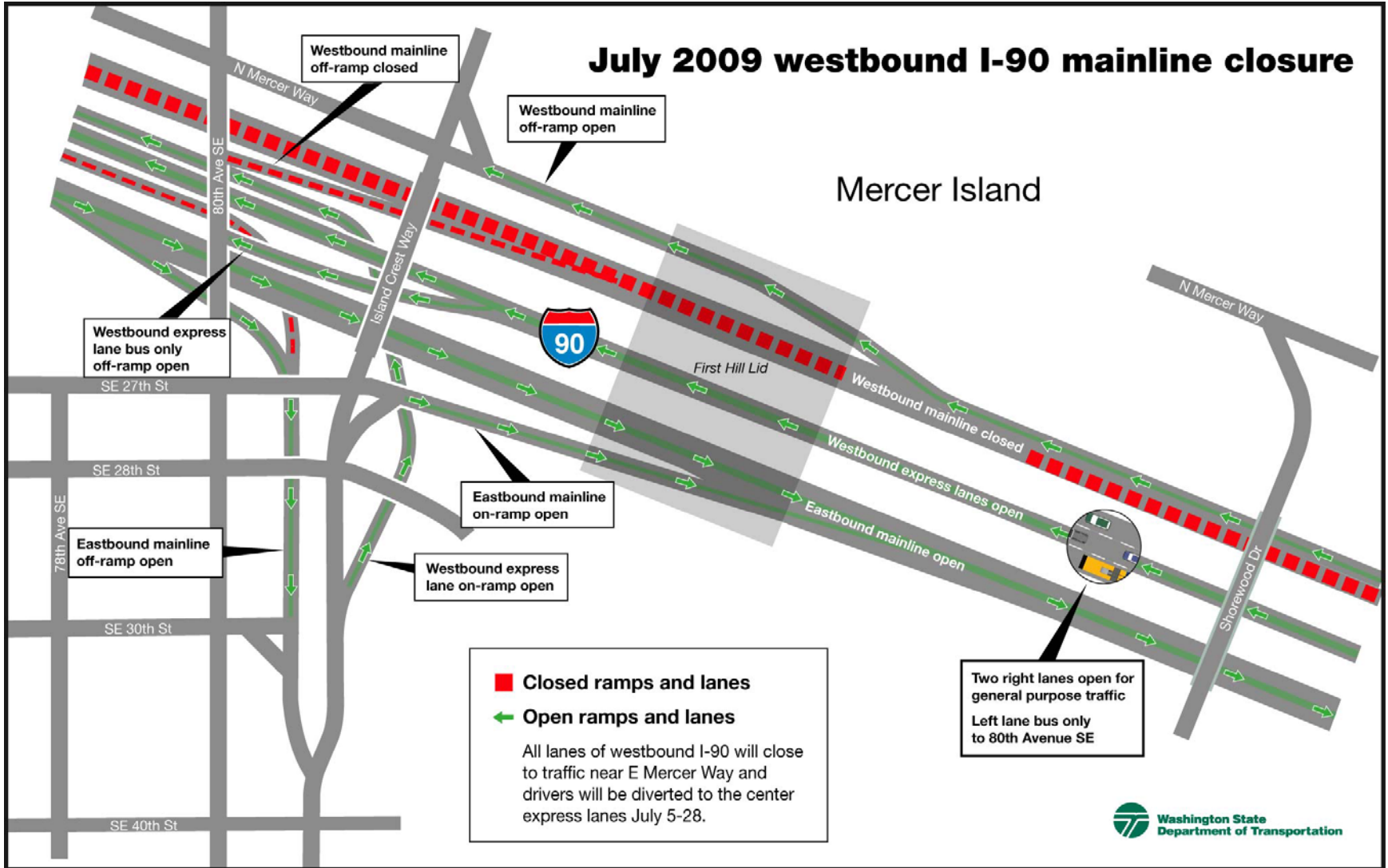



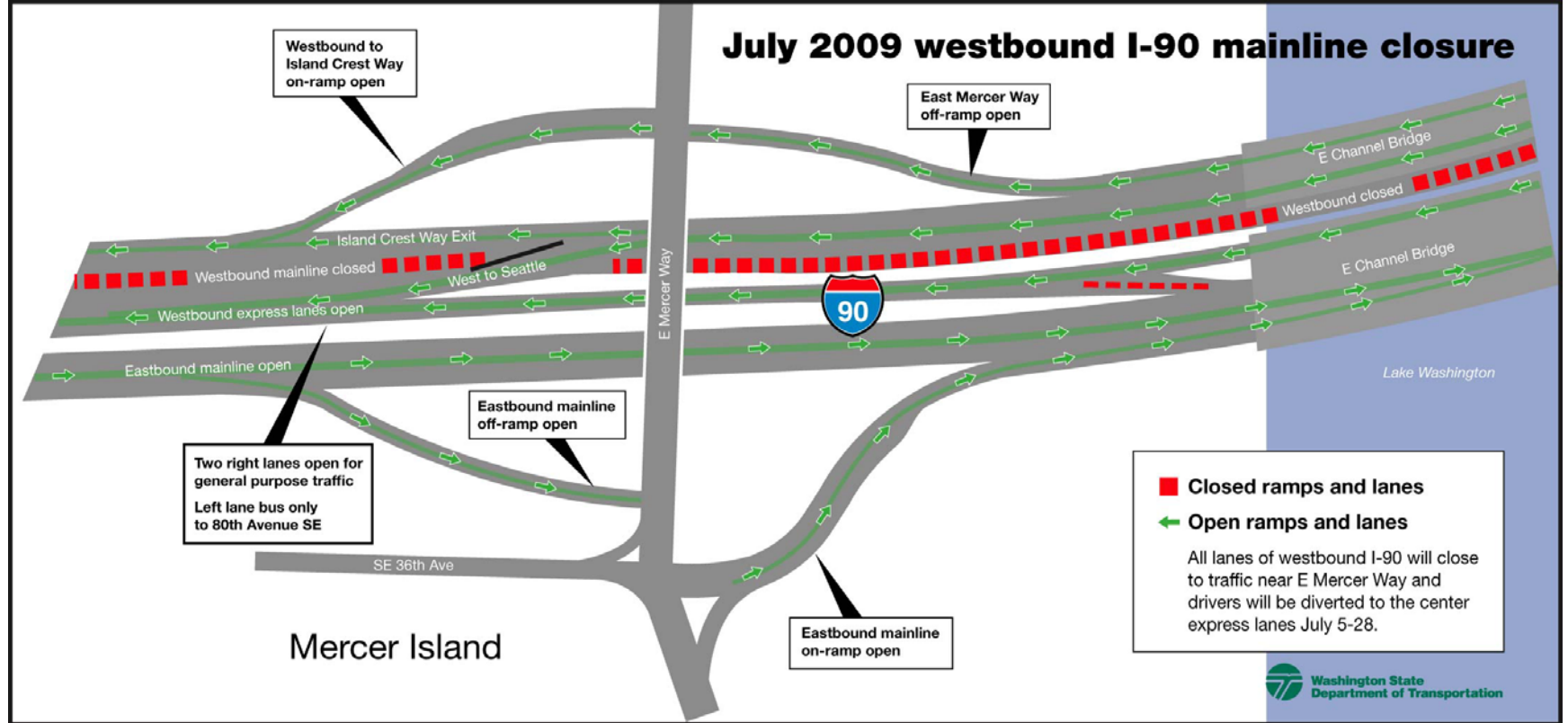

# UNIVERSITY LINK LIGHT RAIL

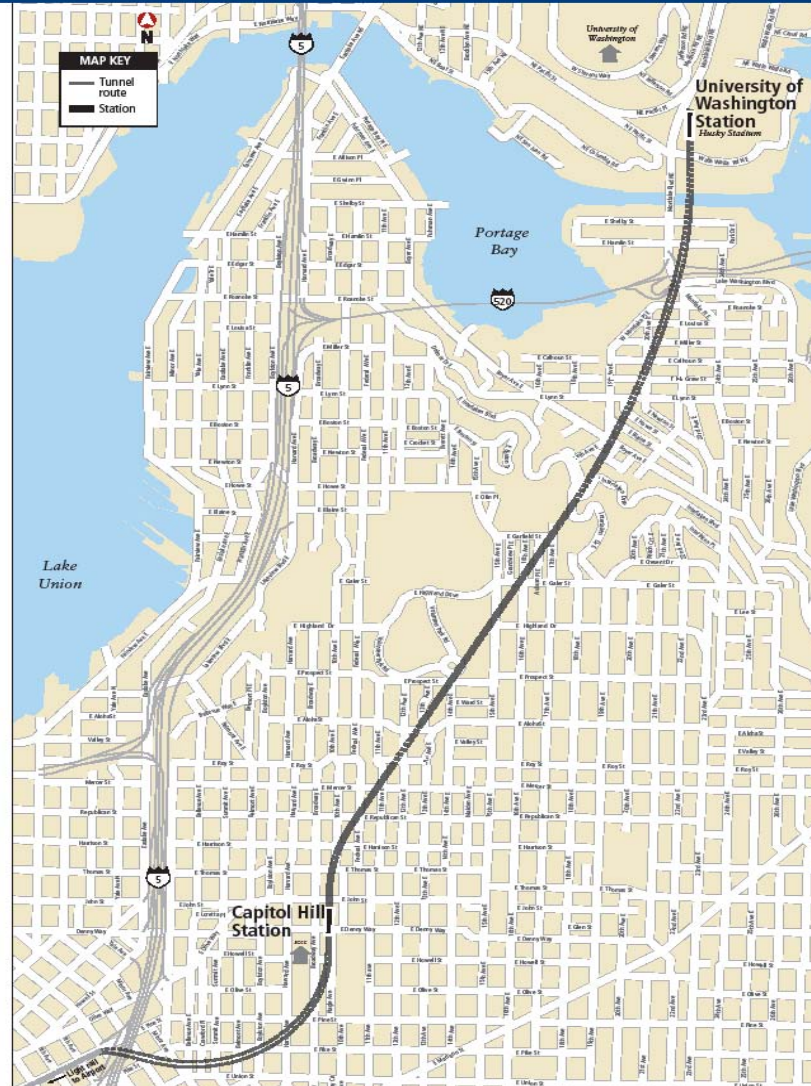

2009 Design Construction Conference

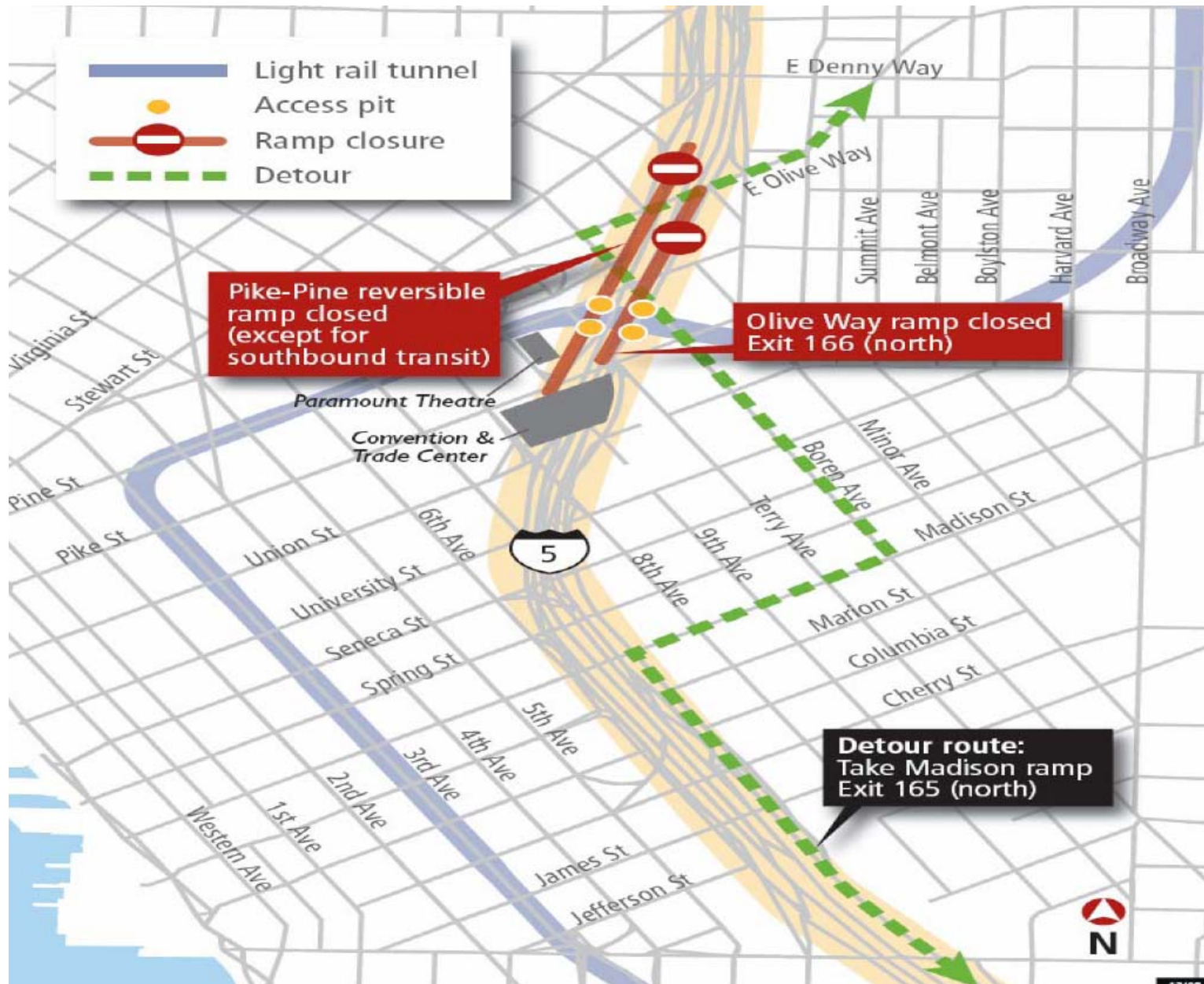

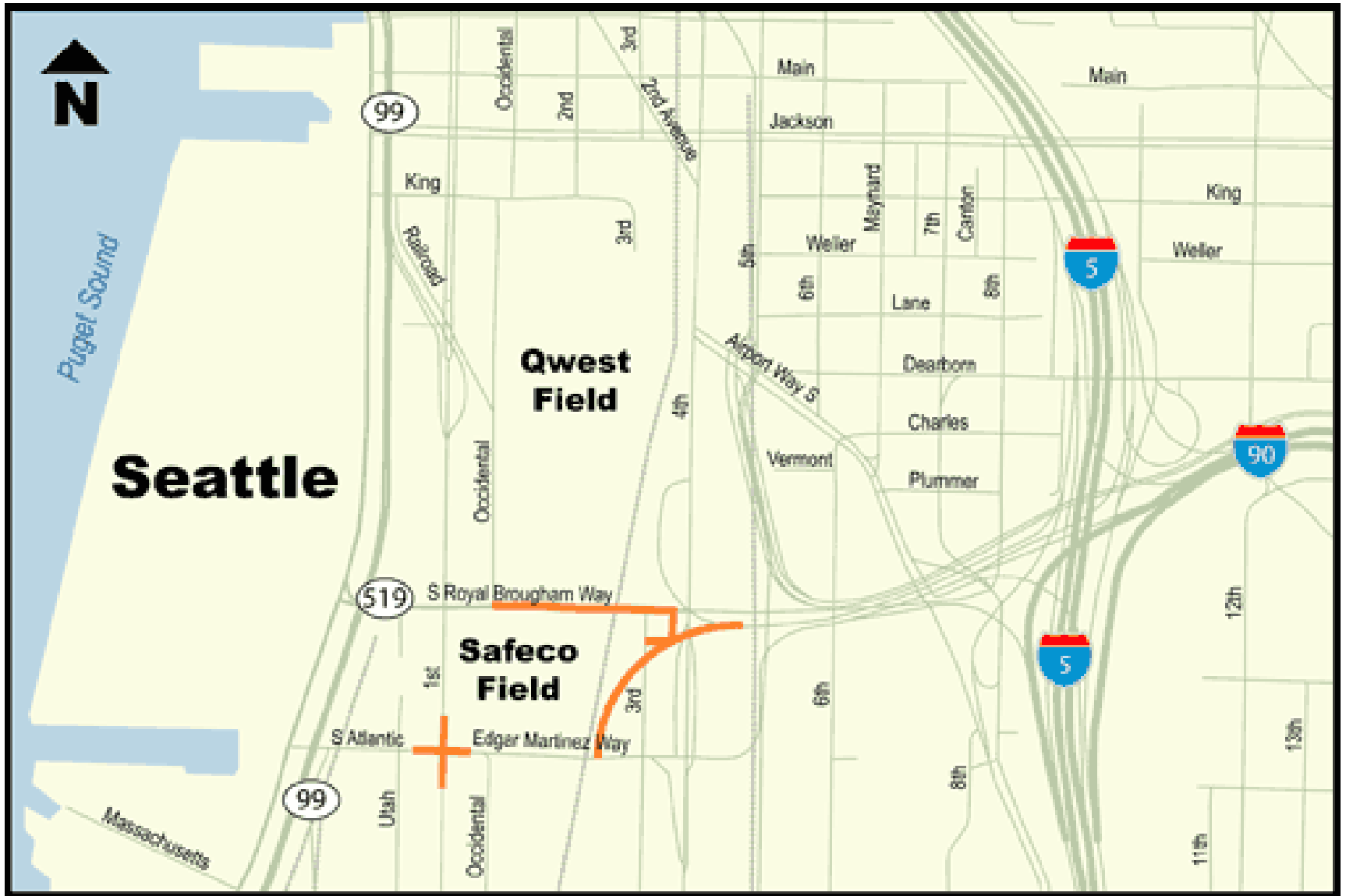

2009 Design Construction Conference



## SR 519 Intermodal Access Project – Phase 2

519

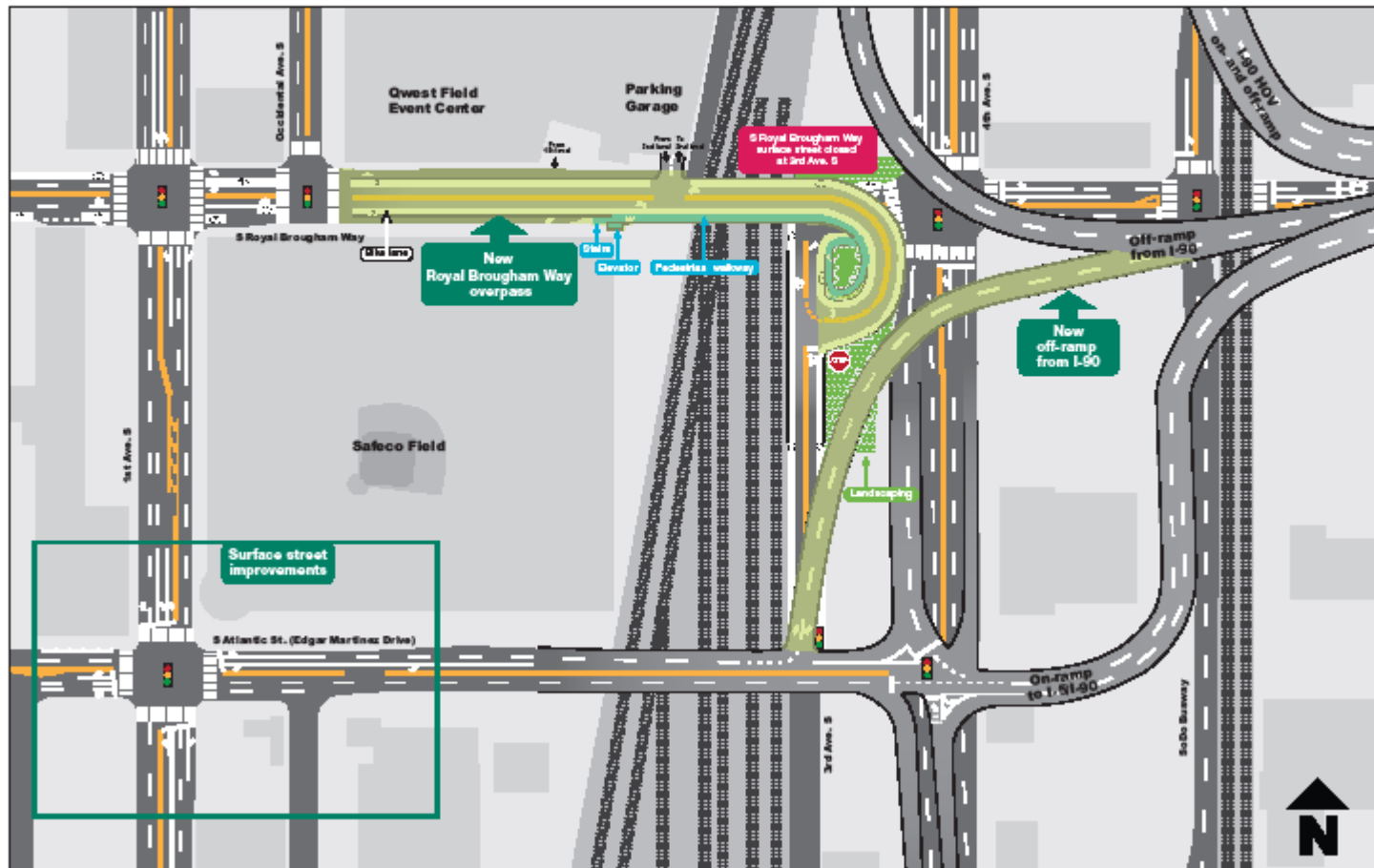

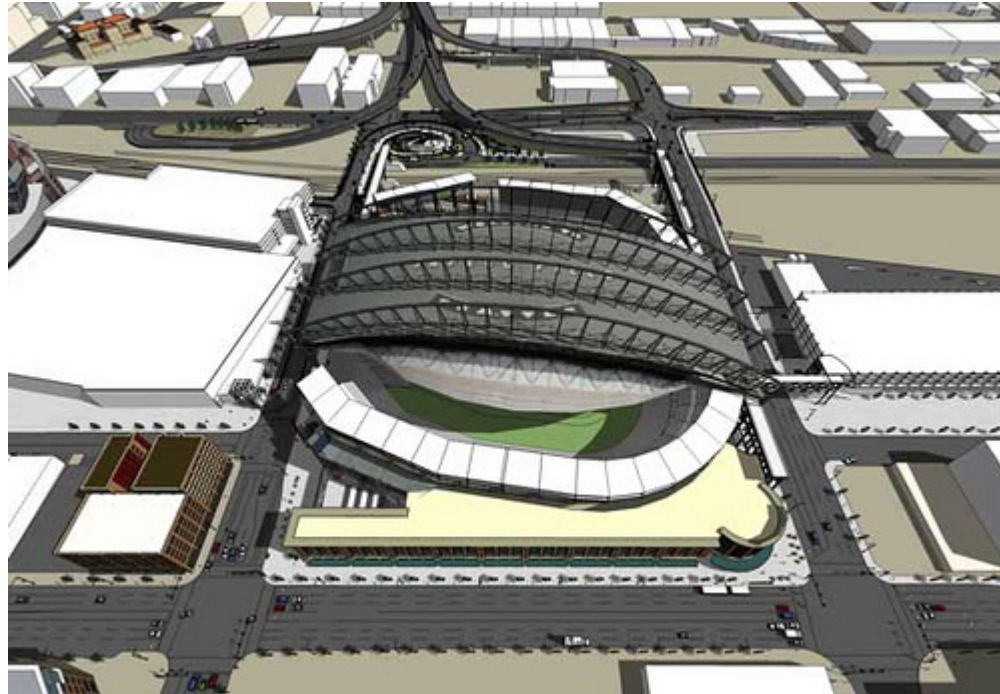

2009 Design Construction Conference



2009 Design Construction Conference